

Flaxmere
General Ward
LG-030-2022-W-5

SH 50A

HASTINGS- HAVELOCK NORTH GENERAL WARD

(See Sheet 2)

Hastings

Heretaunga
General Ward
LG-030-2022-W4

SH 2

Kahurānaki
General Ward
LG-030-2022-W-7

HASTINGS- HAVELOCK NORTH GENERAL WARD

(See Sheet 3)

Kahurānaki
General Ward
LG-030-2022-W-7

Havelock
North

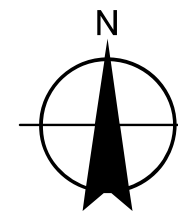

Notes:

1. Coordinates are in terms of New Zealand Transverse Mercator 2000 (NZTM).
2. Where a boundary is shown along a river or road it follows the middle line of the river or legal road unless otherwise shown.
3. All seaward boundaries follow Mean Low Water Springs but cross the mouths of all rivers, streams, inlets and estuaries except where shown otherwise.

0 0.5 1 2 Kilometres

Land District: Hawkes Bay

HASTINGS DISTRICT HASTINGS-HAVELOCK NORTH GENERAL WARD

TERRITORIAL AUTHORITY: Hastings District

Compiled by Jacobs New Zealand Limited

Scale 1:43,000 at A3 Date May 2022

LG-030-2022-W-6

Sheet 1 of 6

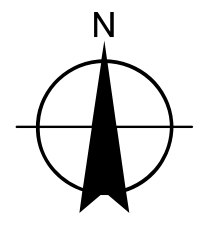
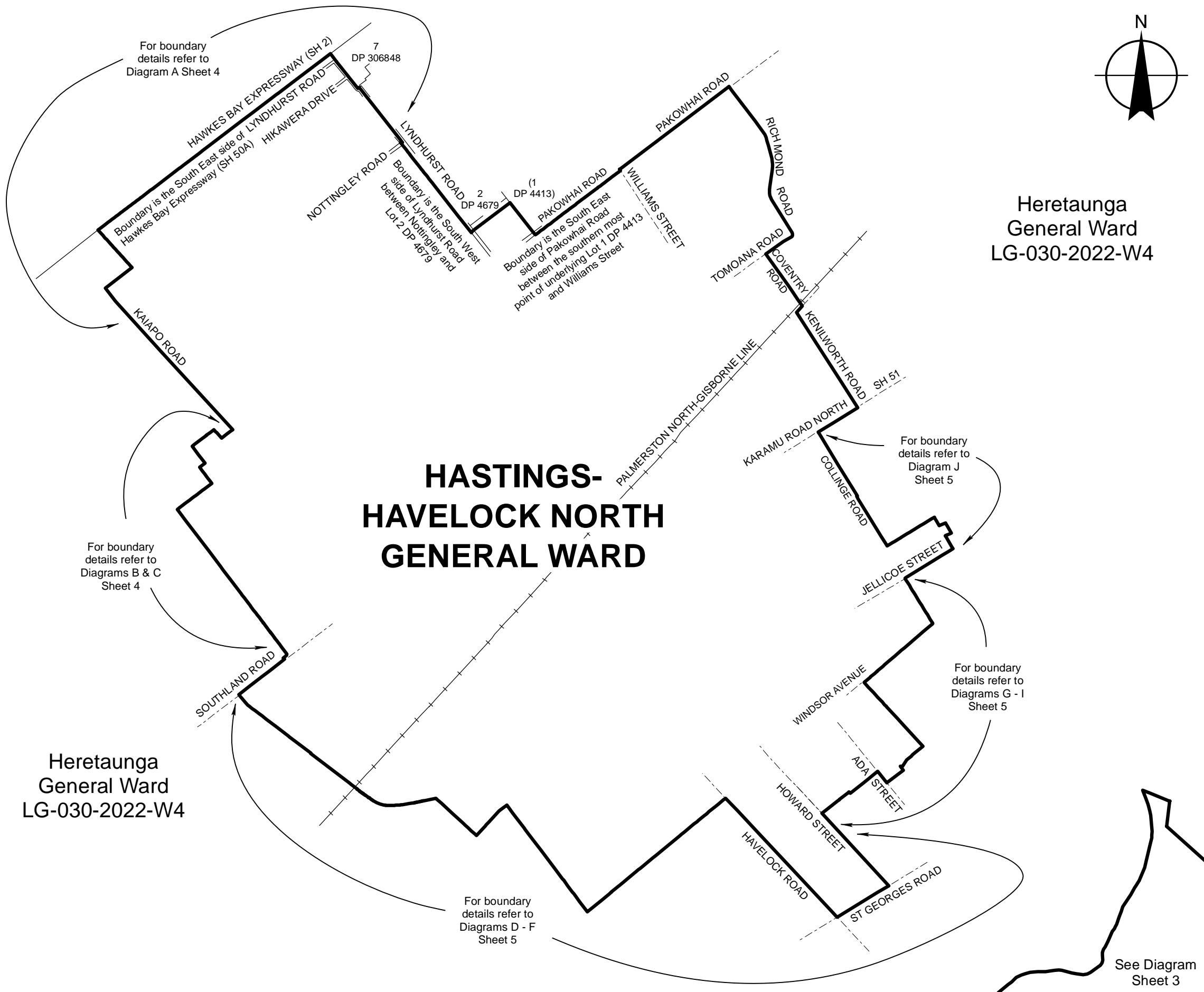

Heretaunga
General Ward
LG-030-2022-W4

- Notes:
1. Where a boundary is shown along a river or road it follows the middle line of the river or legal road unless otherwise shown.
 2. All seaward boundaries follow Mean Low Water Springs but cross the mouths of all rivers, streams, inlets and estuaries except where shown otherwise.

For boundary details refer to Diagrams B & C Sheet 4

For boundary details refer to Diagram J Sheet 5

For boundary details refer to Diagrams G - I Sheet 5

For boundary details refer to Diagrams D - F Sheet 5

See Diagram Sheet 3

Heretaunga
General Ward
LG-030-2022-W4

HASTINGS DISTRICT
HASTINGS-HAVELOCK NORTH
GENERAL WARD

Land District: Hawkes Bay

TERRITORIAL AUTHORITY: Hastings District
Compiled by Jacobs New Zealand Limited
Scale 1:24,000 at A3 Date May 2022

LG-030-2022-W-6
Sheet 2 of 6

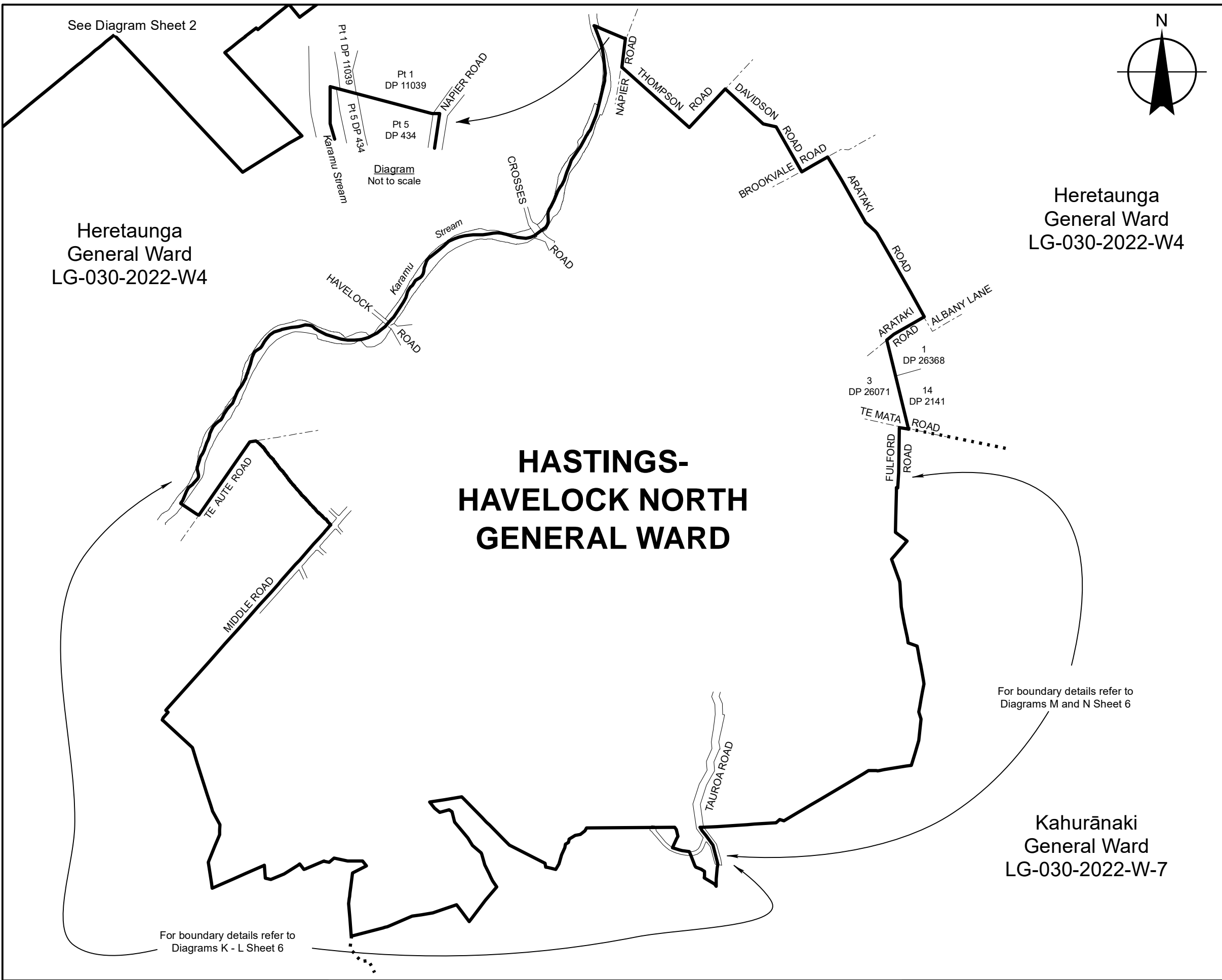

- Notes:
1. Where a boundary is shown along a river or road it follows the middle line of the river or legal road unless otherwise shown.
 2. All seaward boundaries follow Mean Low Water Springs but cross the mouths of all rivers, streams, inlets and estuaries except where shown otherwise.

Land District: Hawkes Bay

File IZ049800

HASTINGS DISTRICT
HASTINGS-HAVELOCK NORTH
GENERAL WARD

TERRITORIAL AUTHORITY: Hastings District
 Compiled by Jacobs New Zealand Limited
 Scale 1:20,000 at A3 Date May 2022

LG-030-2022-W-6
 Sheet 3 of 6

Notes:

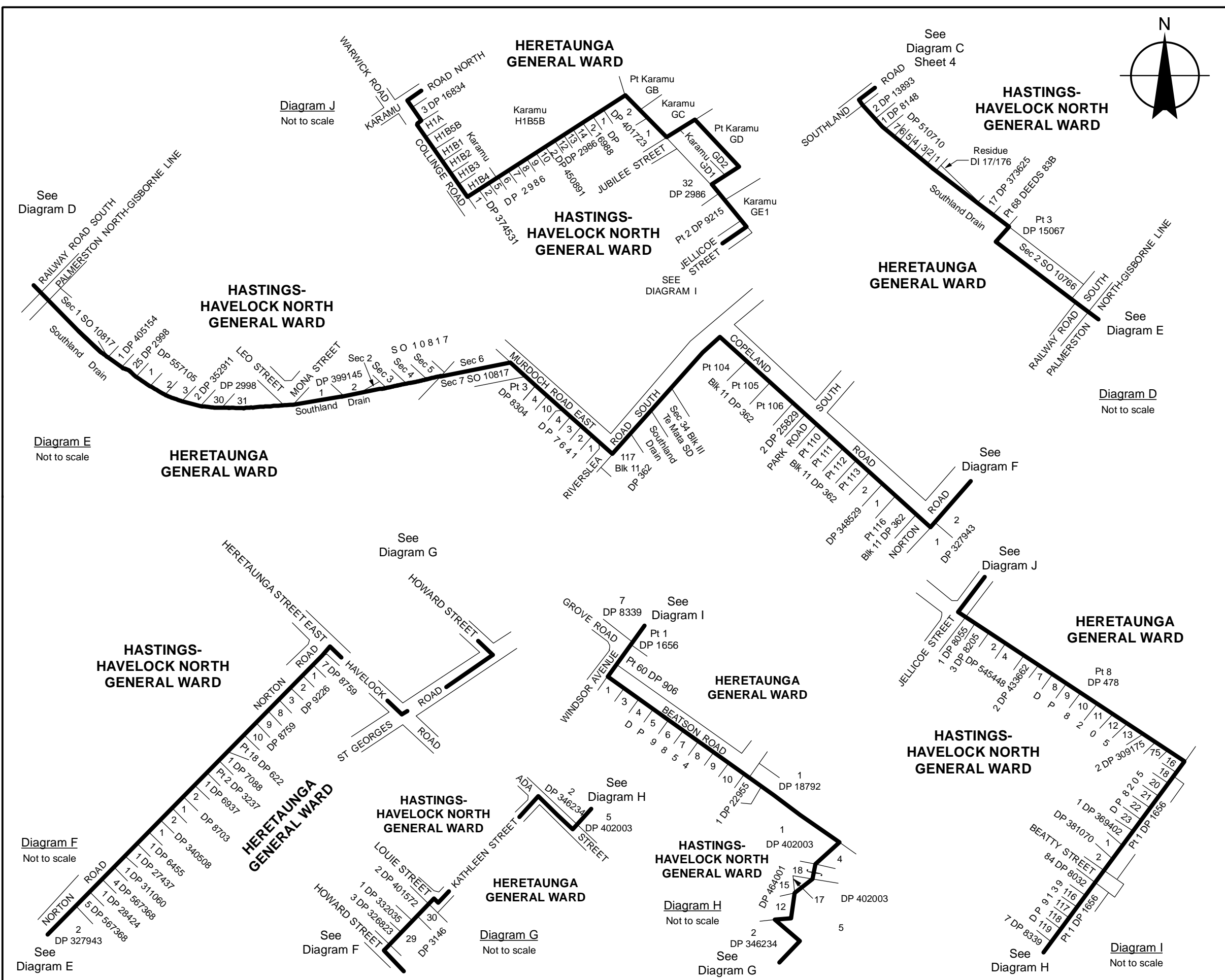
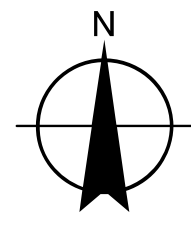

Land District: Hawkes Bay
File IZ049800

HASTINGS DISTRICT HASTINGS-HAVELOCK NORTH GENERAL WARD

TERRITORIAL AUTHORITY: Hastings District
Compiled by Jacobs New Zealand Limited
Not To Scale Date May 2022

LG-030-2022-W-6
Sheet 5 of 6

Notes:

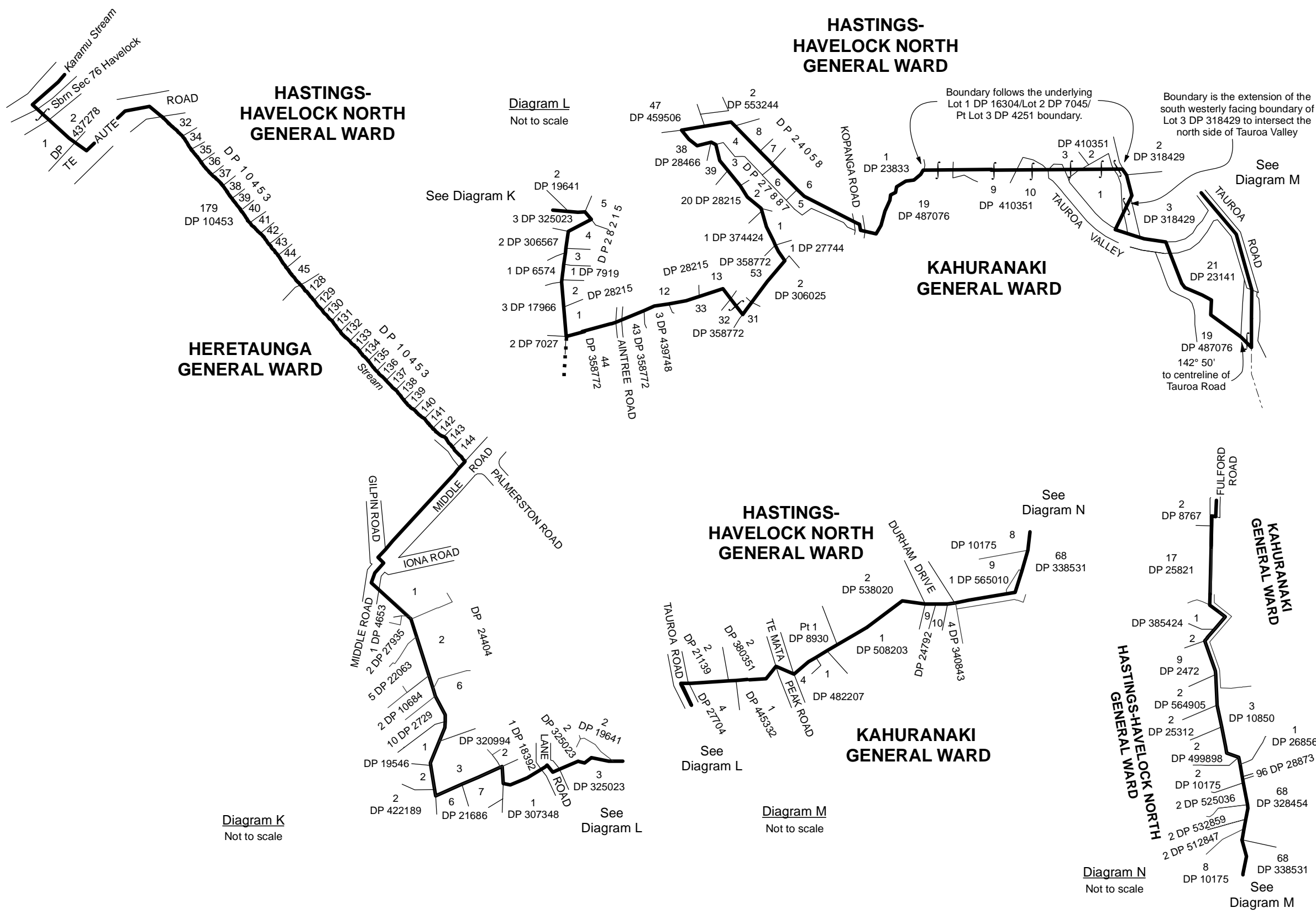
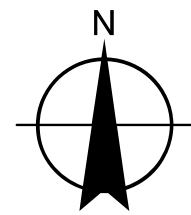

Land District: Hawkes Bay

File IZ049800

HASTINGS DISTRICT

HASTINGS-HAVELOCK NORTH GENERAL WARD

TERRITORIAL AUTHORITY: Hastings District

Compiled by Jacobs New Zealand Limited

Not To Scale Date May 2022

LG-030-2022-W-6

Sheet 6 of 6