



GATEWAY WITHIN HASTINGS DISTRICT

Work is currently underway on beautifying the key roundabout entrances into Hastings City and the District. This work first began in 2009 when Officers identified that there was an opportunity to enhance the amenity at roundabouts along key routes into Hastings, Havelock North and Flaxmere. These enhancements generally included shrub and annual planting surrounded by a belt of grass.

In 2011, work was undertaken at the Longlands Road/SH50A & York Road/SH50A roundabouts in conjunction with scheduled NZTA roading projects. This year Council is hoping to undertake similar treatments at the following locations - Evenden Road/SH50A and Pakowhai/Evenden Road roundabouts. This work is pending negotiations with NZTA and the availability of services nearby e.g. water supply for irrigation of annual beds.

In addition to the roundabout enhancements, Officers have been working with a design collective, lead by Band Ltd, to develop a generic 'gateway' structure, in line with the objectives set out in the Landmarks Development Plan.



Initial concepts have been received well by the Landmarks Advisory Group and community representatives. Further work is required to finalise the location of these structures and what form they may take at each location, as well as defining the costs and likely funding model and programme for rolling these out in the future.

WILLIAM NELSON PARK

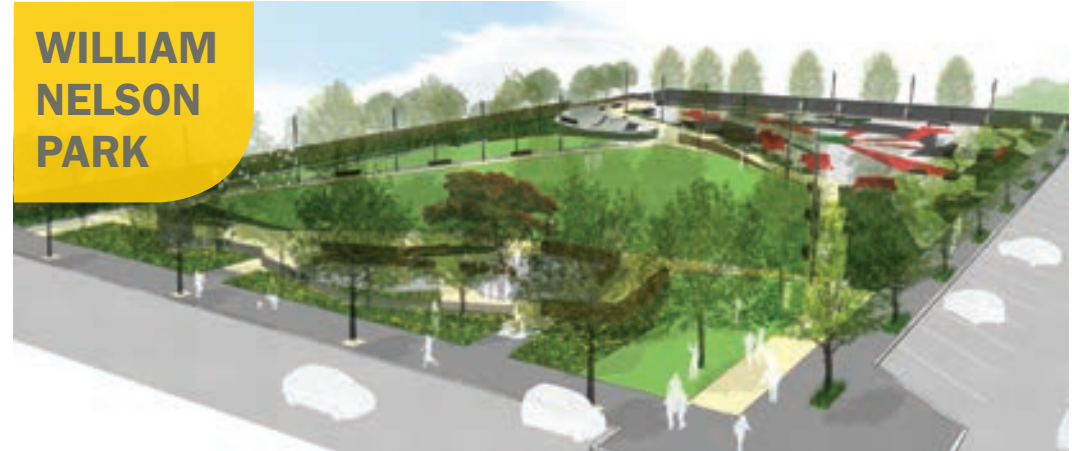

In February 2011, Council purchased the 6000m² vacant site bounded by St Aubyn Street, King Street and Avenue Road, from funds secured from the sale of Nelson Park to purchase of additional inner city Greenspace. The majority of the site will be a passive recreation park, with a children's playground, water feature, toilet and open grassed area and significant landscaping. The rest of the site will incorporate an urban skate plaza and bowl, designed by prominent NZ skatepark designer Jason Parkes.

Generous grants have been secured from various Trusts with Officers now working on a corporate sponsorship package to finalise the remaining funding to ensure that the development will proceed on target, in the hope of opening it this summer.

Site clearance started in August, with development due to begin in early October, if all funding is in place. The Youth Council and Atomic are leading a programme of public awareness for the project, with a number of fundraising events planned in the coming months.

Following consultation with the Landmarks Executive Trust, Council at their meeting on the 23rd August resolved to name the park, William Nelson Park. This followed a request by the family following the sale of the

original Nelson Park, that his legacy to the district be recognised by naming the park in his honour.

The name is a fitting tribute to a man who gave an enormous amount of time and energy during the early days of the development of Hastings District.

William Nelson's lasting legacy is his generosity as a benefactor, and the creation of employment and wealth through the Tomoana Freezing Works, which helped build the economic prosperity of Hastings in the late 1800s and early 1900s. Upon his death many acknowledged him as 'The Father of Hawke's Bay' in recognition of his contribution to the whole province.

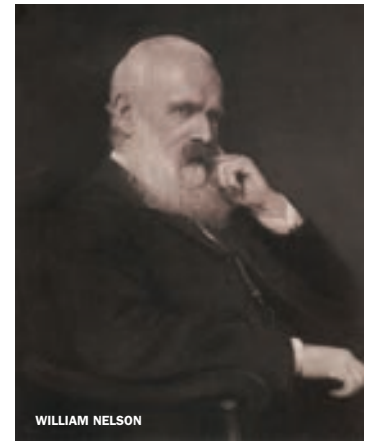

WILLIAM NELSON

NEXT HISTORY TALK

Tuesday 11 September

Hastings War Memorial Library
5:30pm
(gold coin gratuity)

Ian Granger -
'Hawke's Bay's aviation history'

ROSE SUNDAY

This year's event will include the opening of the new Rose Garden Pavilion and Walkway

on

Sunday 25 November
1-3pm

More details to follow

STONECROFT RESERVE & HOMESTEAD

To be officially opened to the public by Mayor Lawrence Yule

on

Saturday 1 December
1pm onwards

More details to follow

ROYS HILL OPEN FOR BUSINESS

After several years of community planting days and site restoration, Roy's Hill Reserve was officially opened to the public on the 25th March 2012. Support from local businesses and a grant from the Landcare Foundation allowed for additional planting and irrigation, the construction of a carpark and the installation of new picnic tables and information boards within the reserve.

This special and unique site offers impressive 360 degree views, taking in all of the district's spectacular landmarks. It is hoped that this newly restored site, with its spectacular panoramic views over the Gimblett Gravels will become a popular area of open space, for both locals and tourists alike.

The opening was a huge success, offering plenty of entertainment for the whole family, including bouncy castle, train rides and an aerial display by the Hawke's Bay Radio Flyers.



CENTRAL CHARACTER PRECINCT SIGN GUIDE

With endorsement from the Landmarks Advisory Group, Council has produced a 'Sign Design Guide' or 'good practice guide', which provides guidance on the design, size and location of new signs on buildings located within the Central Character Precinct of the Hastings CBD.

Signs are a vital part of the city, allowing people to promote their business or activities as well as directing and informing people. Well designed signs can add to the vitality of the street, but poorly designed signs can detract from the experience of the city, obscuring building features and giving a cluttered, disorganised appearance. This is particularly so within the CBD where there are a large number of signs in a condensed area which can obscure and diminish important heritage features.



The Sign Design Guide is now being used by Officers in the consideration of resource consent applications, and in advice being provided to the public. Officers have also presented the Sign Design Guide to a meeting of the Hastings Business Association, where it was received well by those retailers present.

The next step will be to provide a copy to all business and building owners in the CBD, as well as sign writing businesses, once an Incentive Scheme has been finalised and supported by Council.

This new Sign Design Guide will hopefully be used as a source of inspiration for retailers in the design of new signs, and together with an Incentive Scheme (as an extension to the Façade Enhancement Scheme) should encourage good practice and good signs, in keeping with the character and style of our heritage buildings.

COME OUT TO PLAY IN HASTINGS' NEWEST PLAYGROUND

As a result of a community instigated effort, and a joint Council and Housing New Zealand initiative, a new reserve and playground was officially opened by Mayor Lawrence Yule on Saturday 26 May 2012.

The new park, located on the corner of Cobham Place and Cobham Street, offers over 1400m² of recreation space in the heart of Raureka. The local residents requested that their new park be named Whenua Takoha Reserve, meaning the "gift of land."

The park contains a playground aimed at meeting the needs of the younger children of the neighbourhood. The final result sees a vacant lot transformed into a well used recreation asset for Raureka.



IWAY ROLLS ON

WHAKATU

The second year of the iWay programme has now been successfully completed.

The new 9km off-road route from Hastings to Clive has opened up an easy link from Hastings to the coastal cycle trails for the first time. The route includes a new wooden suspension bridge over the Karamu Stream and a 1km riverside link from Whakatu to Clive. This part of the route has been embraced by the Whakatu community, who organised a community planting day along it in May, with an opening event for the route being planned for early October.



HAVELOCK NORTH

Over 800 people celebrated the opening of the long-awaited Havelock Road pathway, which was officially opened in July by Mayor Lawrence Yule and local MP Craig Foss. The pathway provides a safe off-road 3m wide facility for both pedestrians and cyclists and is already seeing plenty of use.

Also cyclists and bus users alike will have noticed the new shelter erected along Te Mata Rd in June of this year. It's a result of a collaboration between HDC & HBRC and is the first of 3 to be installed.

The idea is that you can now bike to a bus stop near you, leave your bike there safely and catch the bus for the rest of your journey. The shelter includes historic pictures of cyclists from around the District, including Havelock North, which were discovered in local archives.



INFORMATION BOARD TO HONOUR ORIGINAL HAVELOCK NORTH TOWN BOARD

A short ceremony will mark the installation of a new historical information board in the Havelock North CBD that commemorates the formation of the Havelock North Town Board, 100 years ago. The Board was constituted on February 6th, 1912 and the first meeting was held on Friday August 23rd 1912 in the Foresters Lodge.

Havelock North Councillor Scott Henderson says "It is appropriate that the formation of the Board in 1912 is acknowledged with the information board, which will be positioned outside the Havelock North i-Site. The board will include a brief history of the growth of the village, and photographs of some of the more recognizable buildings of that time."

The information board will be officially revealed by Mayor Lawrence Yule during a ceremony at 12.45pm on Thursday August 23rd outside the i-Site in Havelock North. Members of the public are welcome to attend the ceremony.

Local historian Michael Fowler will give a talk on the history of the village, at the Havelock North Function Centre at 7.30pm on Thursday 23rd, August, 2012. The talk is sponsored by Hastings District Council and entry is by a gold coin donation.